

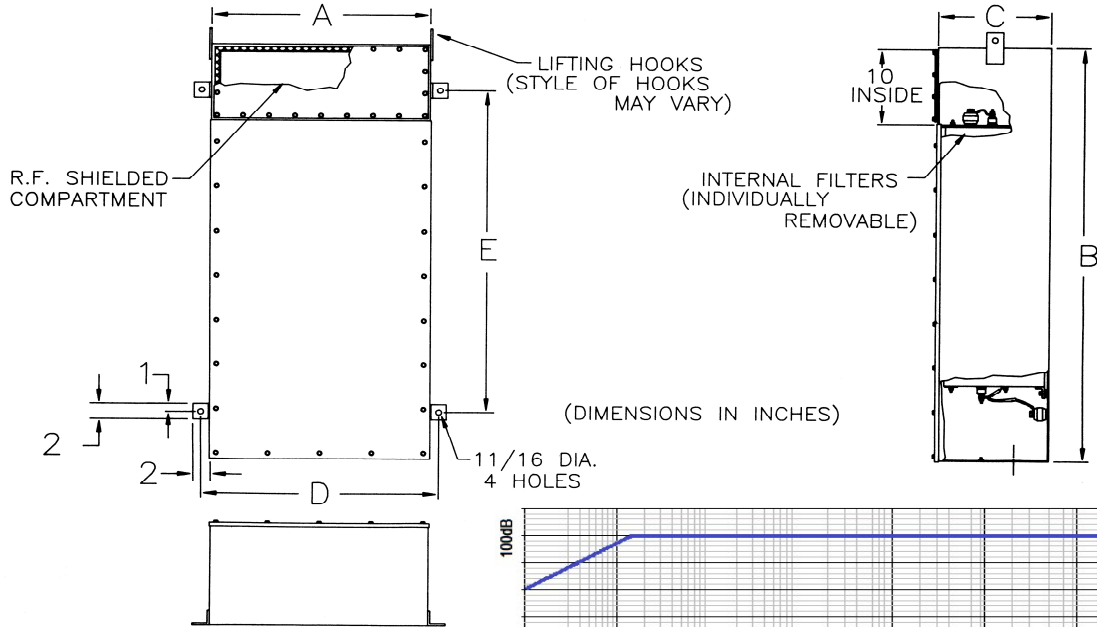

HEMP Filter Cabinets

*For Tempest Application 100dB from 14kHz to 10GHz
IAW UL Safety Specification 1283*



NOTES:

1. Filters are listed per UL specification #1283
2. Temperature Range: Operating -55°C to +85°C
3. Enclosures are made from cold rolled steel with continuously welded seams
4. Filter ground path connecting surfaces shall be tin plated or stainless steel
5. Conduit hubs or clearance holes may be provided if specified when ordering
6. Each phase filter is individually removable
7. Internal filters are filled with a non-flammable impregnant and hermetically sealed
8. Legs for floor mounting may be provided if specified when ordering
9. Filters for 300AMP and up have 6" x 2" mounting U-Channel

Part Number	Current Rating (AMP)	Voltage Rating		Frequency Rating (Hz)	Dimensions (INCHES)					Weight Approx. (LBS)
		LG / LL VAC	VDC		A±.060	B±.060	C±.060	D±.060	E±.060	
FCULX-4 X 30E2 HEMP	4 x 30	277 / 480	600	60	28	38	6	64	26	220
FCULX-4 X 60E2 HEMP	4 x 60	277 / 480	600	60	28	41	8	64	29	315
FCULX-4 X 100E2 HEMP	4 x 100	277 / 480	600	60	57	60	10	80	48	520
FCULX-4 X 225E2 HEMP	4 x 225	277 / 480	600	60	28	60	16	64	48	750
FCULX-4 X 250E2 HEMP	4 x 250	277 / 480	600	60	28	60	16	64	42	750
FCULX-4 X 300E2 HEMP	4 x 300	277 / 480	600	60	60	84	16	66	44	850
FCULX-4 X 400E2 HEMP	4 x 400	277 / 480	600	60	60	84	16	66	44	975
FCULX-4 X 500E2 HEMP	4 x 500	277 / 480	600	60	60	84	16	66	44	1075
FCULX-4 X 600E2 HEMP	4 x 600	277 / 480	600	60	45	84	34	38	44	1600
FCULX-4 X 800E2 HEMP	4 x 800	277 / 480	600	60	60	72	34	66	44	2400
FCULX-4 X 1000E2 HEMP	4 x 1000	277 / 480	600	60	60	72	34	66	44	2500
FCULX-4 X 1200E2 HEMP	4 x 1200	277 / 480	600	60	60	72	34	64	44	2750
FCULX-4 X 1500E2 HEMP	4 x 1500	277 / 480	600	60	60	72	34	64	44	2900

*All Filter Cabinets are also available in 3 line and 4 line configuration

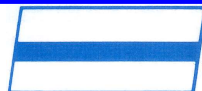



Series FCHS- HEMP Single Individual Filter Elements

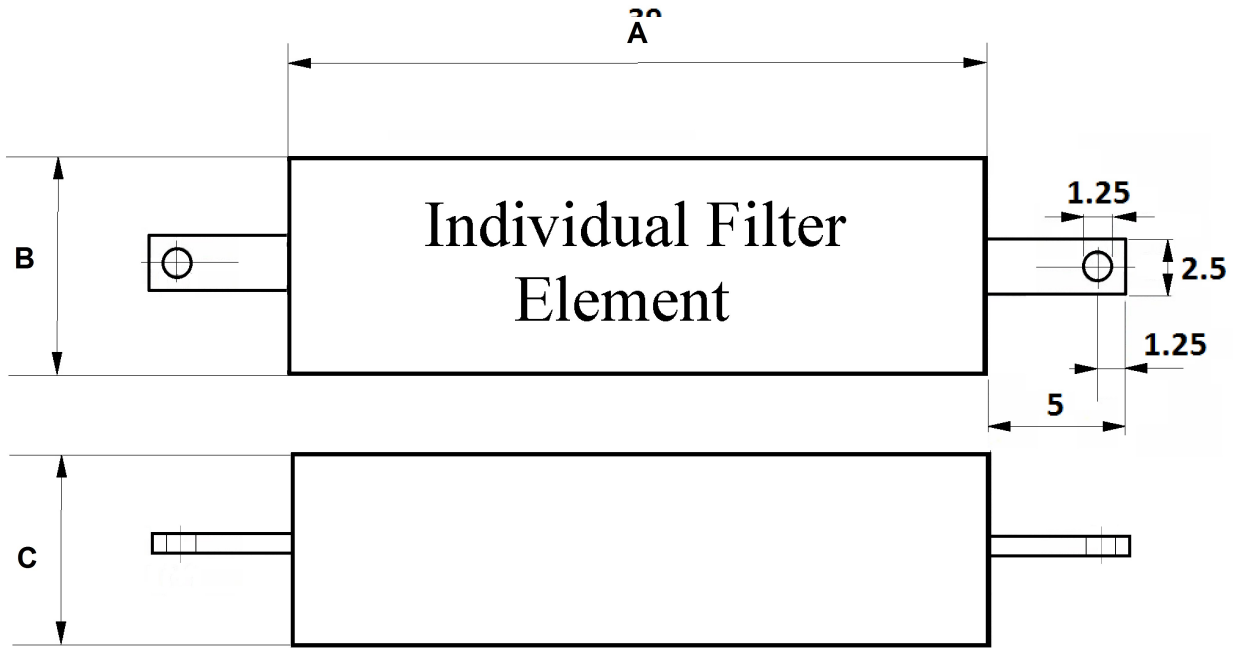

PART NO	CURRENT RATING (AMP)	VOLTAGE RATING (VAC)	FREQ RATING (HZ)	WIRE SIZE	DIMENSIONS (INCH)			INSERTION LOSS (DB)				
					A	B	C	100kHz	1MHz	10MHz	100MHz	1GHz
FCH-800-E2	800	277	0-60	2.5 x 0.5 Bus Bar	35	17	14	80	80	80	80	80
FCH-400-E2	400	277	0-60	250MCM	32	16	12	80	80	80	80	80
FCH-100-E2	100	277	0-60	#2	30	14	10	80	80	80	80	80
FCH-60-E2	60	277	0-60	#10	28	14	8	80	80	80	80	80
FCH-30-E2	30	277	0-60	#10	28	14	6	80	80	80	80	80





Series FCHS: HEMP Single Individual Filter Elements

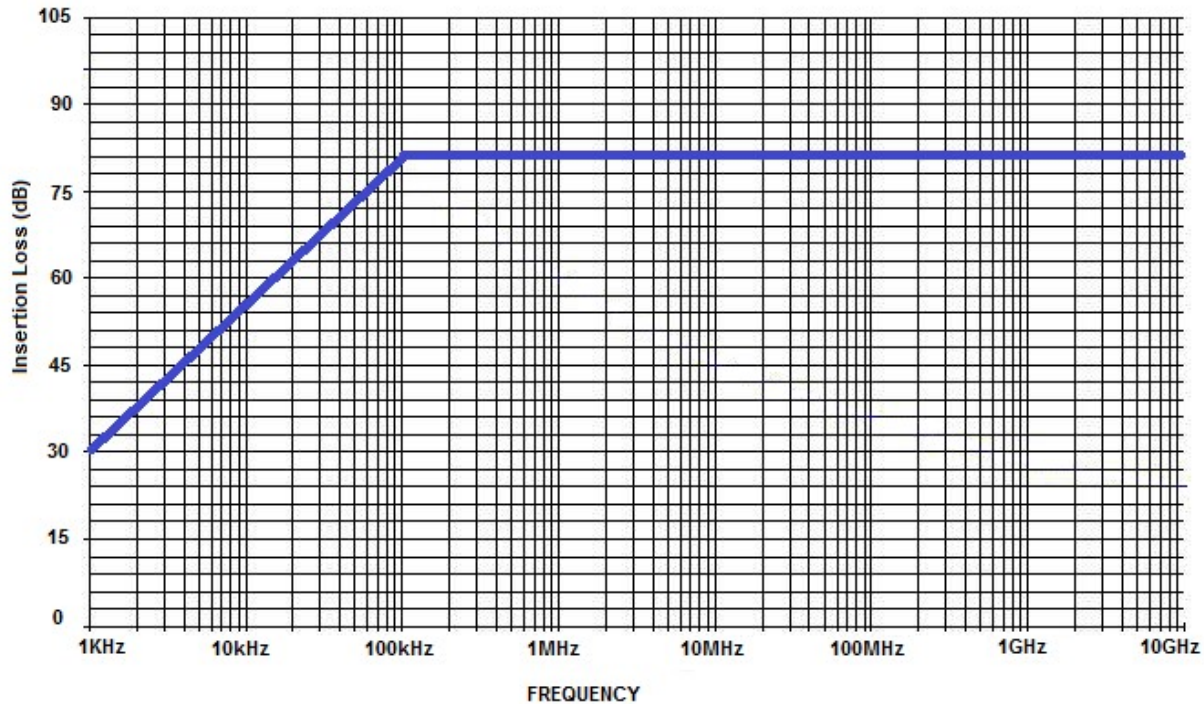

ELECTRICAL

CURRENT RATING: The filters shall be capable of withstanding 140% of rated current for 15 minutes without any deterioration.

INSERTION LOSS: The filter shall provide the specified insertion loss of 80 db minimum over its indicated frequency range when measured in accordance with the applicable MIL-STD-220C by a government approved laboratory.

VOLTAGE: The filters shall be capable of operating continuously at full- rated voltage and of withstanding an initial voltage test of twice the rated voltage for one minute.

MECHANICAL

CASE: The filter case shall be made of cold-rolled steel.

FINISH: All filter cases shall be made corrosion-resistant with suitable lacquer over primer. All unfinished grounding surfaces shall be protected by suitable plating.

IMPREGNANT: The impregnant shall be non-flammable as classified by Underwriters Laboratories.

TERMINALS: The terminals shall be made of high temperature alumina ceramic. The ceramic terminal shall have a flexible insulated lead, one end of which is permanently affixed to the terminal. The other end shall be terminated in a permanently affixed lug which shall be mounted on approved flame-retardant insulator.

OPERATING TEMPERATURE

FILTER ELEMENT: Assembly: from 0°F to 104°F (-18°C to 40°C) at rated voltage and full load operations

Components: from 0°F to 150°F (-18°C to 65°C) at rated voltage and full load operations

